

# Assembly of DE Engineers Auto Sheep Feeder.

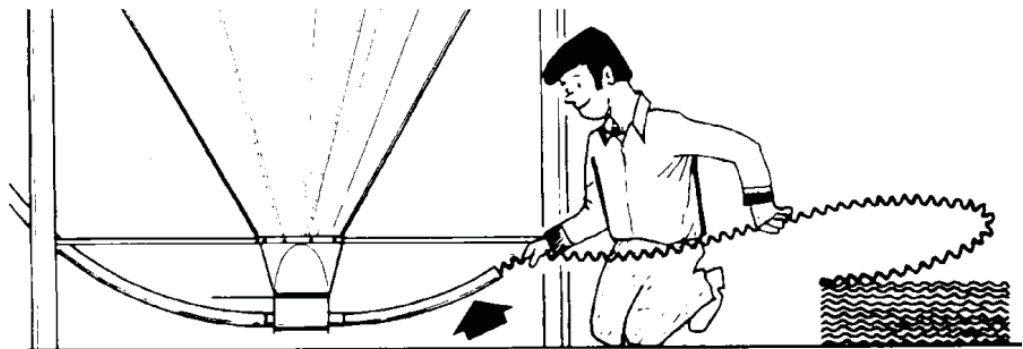

Assemble all feed trays loosely bolting to frames then slide pipe into place with No 1 at controller end.

Slide the auger into the tubes through the rear end of the boot with short strokes.

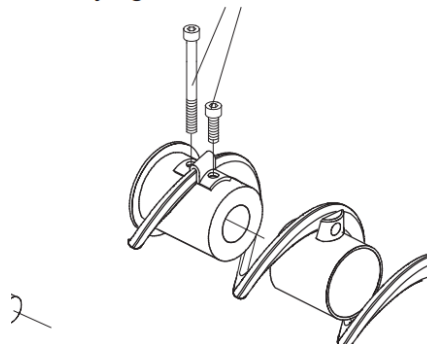

**FIGURE 91.**

You can use a piece of elbow to work more easily.



Firmly tighten the bolts



Push auger through pipe and end cover then connect to motor drive shaft with one bolt through and second shorter bolt into collar.

If the auger has been cut to length, pull auger tight to end of boss and fix with set screw otherwise follow these instructions to cut auger screw level with hopper end (approximately 2 pitches less than total length).

#### TO THE BOOT

Pull a few times at the auger, so it takes its natural length.  
Mark the auger (M) at the rear of the boot.  
Stretch the auger a double pitch and put a new mark (NM), then cut the auger at this new mark.

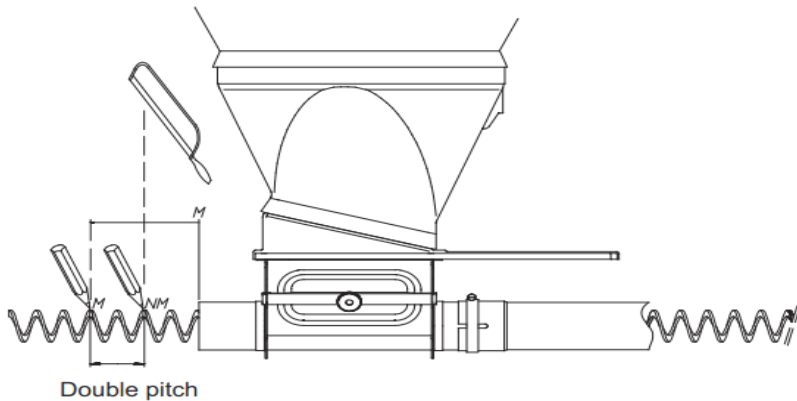
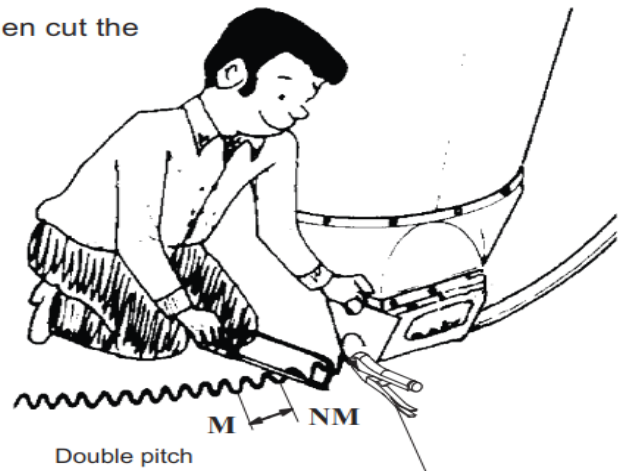

FIGURE 94.



Lock grip pliers



**ALWAYS SEE THAT THE AUGER CANNOT SPRING BACK (BY USING CLAMPS OR A HAMMER IN THE BOOT).**



Firmly tighten the set screw.

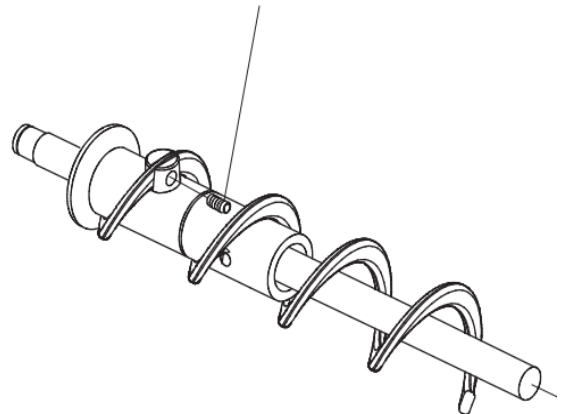

Hoppers are available to fit to silo outlets.

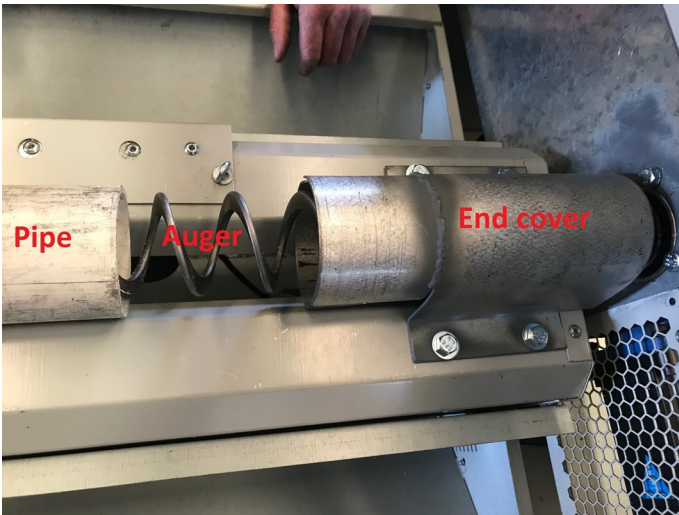

Bolt end cover in place with pipe inside end cover and secure with hose clamp.

Bolt solar panel with leads at controller end with panel facing North.

NB/- The roof sheets with holes in the ribs are for the solar panel supports.



24 volt Motor Controller:

Make sure acceleration and deceleration time is at minimum otherwise the auger will run too long blocking up the tube.

If current limit is set too low the motor will cut out.

Set internal speed control to desired speed.

If motor does not run, turn power off for 30 seconds with main switch then turn on.





When Tek screwing roof panels on to frames make sure frames have foam at edges to form a channel for water to run off the sides at each panel join and be sure not to screw down lid panels too tight flattening foam.

Longer roof panels are at the non-controller end and



Side rain covers have one side bent up and one down while middle rain cover has both sides facing up with the side sheets fitting over the top of middle sheet sides.



Link 12 volt batteries in series at the rear with black link wire positive to negative. Join red controller wire to positive and black controller wire to negative terminal. Connect red bullet connectors in control box to limit switch in feed tray. Swamp leads on the battery periodically to increase battery life.

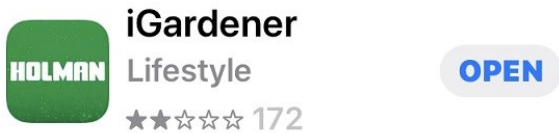

Install Holman iGardner app

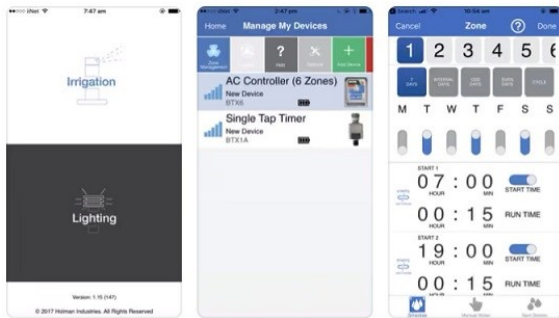

**DEVELOPER**  
**Holman Industries**

Telstra Wi-Fi Call 3:31 pm 51%



Click Irrigation when App is opened.

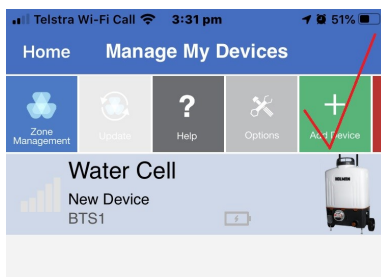
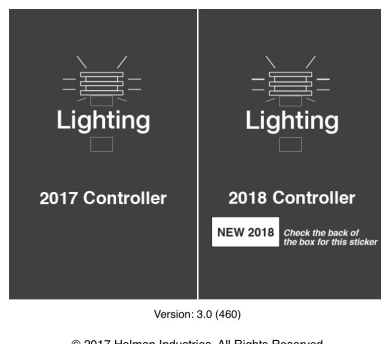

Click Add Device.

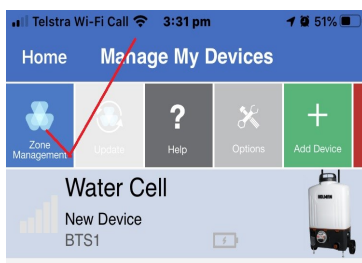

Click Zone Management.

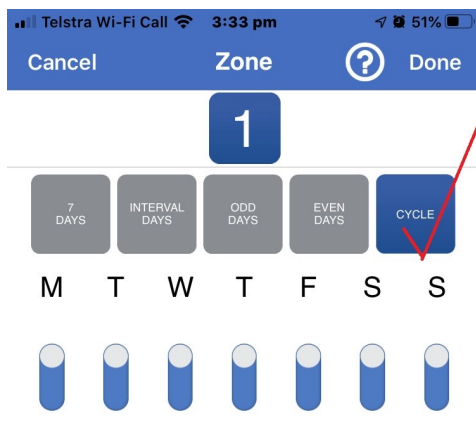

Click CYCLE.

Add start and stop times.

Add run time.

Click Done.

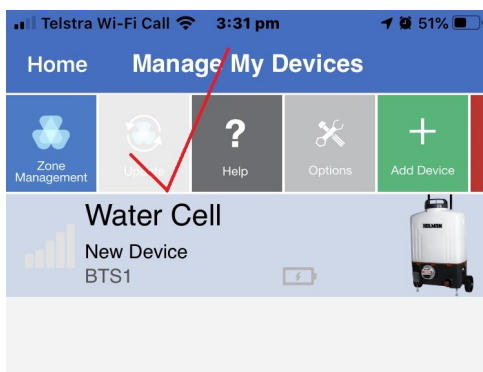

Click update and the timer will start at next start time.

To re-install device or re-set timer:

1. Re-set the timer by pressing the stop button for 15 seconds.
2. Add new device to phone app.

Nb/-Timer will flash a blue light when connection is established.



To start manually: Open the 7 DAYS page, touch the manual water (hand) at the bottom to enter manual water time set-up

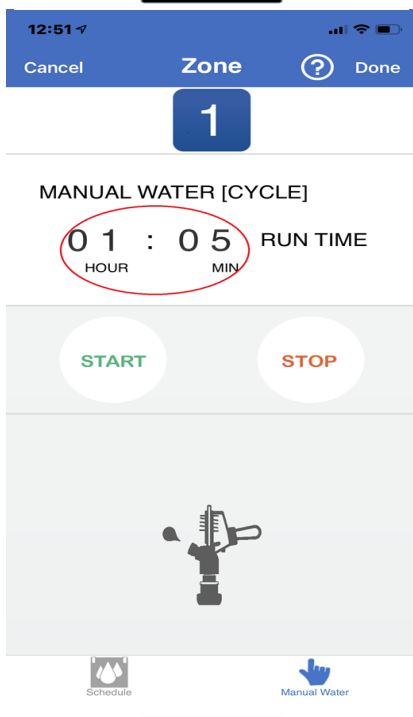

Change Run-Time to desired time to a maximum of 59 minutes, press start then press done.

Nb/- motor will run for a few seconds.

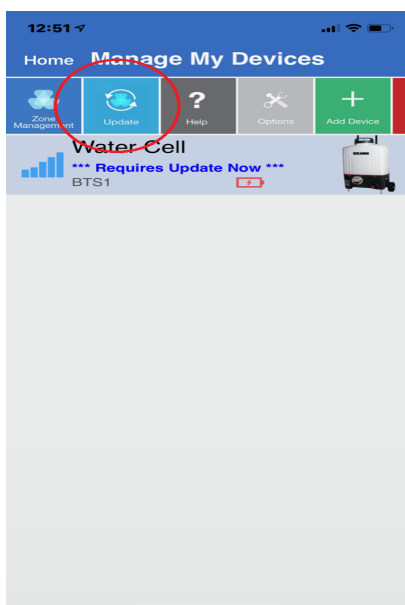

Now you need to press update to store the desired manual run time.

Press start on the timer or app and feeder will run for the desired length of time.

DE ENGINEERS

131 Clayton Street Bellevue, Western Australia, 6056.

Phone: 08 9274 2632 Fax: 08 9274 6618